



National
Trust

Chartwell

Group Bookings 2023





“A day away from Chartwell is a day wasted!”

- Winston Churchill

Contents

About Chartwell	3
Access Statement	4-5
Group Bookings Process....	6-7
Prices and Availability	8-9
Guided Tours.....	10
Additional Talks/ Tours.....	11
Terms and Conditions.....	12
Site Map	13

Thank you for enquiring about Group Bookings at Chartwell. We welcome around 400 tour groups annually to the Churchill estate and are always happy to accommodate new visitors.

Whilst this brochure is an overview of what to expect at Chartwell for any more information or enquiries, please do not hesitate to contact us.

Contact us:

Email: Chartwell.Groupbooking@nationaltrust.org.uk

Phone: 01732 868381



House

Chartwell was once the home of one of Britain's greatest leaders, Sir Winston Churchill. He called this estate home for over 40 years. Chartwell became Churchill's refuge and inspired not only his penmanship but his artistry.

Please be advised that tickets to the house are timed and visitors are expected to self-guide through the mansion. Once inside please feel free to ask our stewards any questions you might have on the treasures that Chartwell possesses.



Gardens

At Chartwell we are extremely proud of our gardens. From the man-made swimming pool, Golden Orfe Pond, Golden Rose Avenue, Lady Churchill's Rose Garden, and the Kitchen Gardens, there is so much beauty to behold.



Studio

Chartwell's studio offers insight into Winston Churchill the painter. The walls of the studio are bedecked with Churchill canvasses, most unframed and in various stages of completion. Due to the small space inside, large groups need to split into smaller groups to visit the studio.

Access Statement

It is **essential** that our access information is read and passed on to every member of the group to avoid disappointment on the day.

Chartwell is situated on a hillside and due to the historic nature of the site there is limited wheelchair access to the house and some parts of the garden. We have listed key points below but a full access statement is also available on request.

House

The car park is 250 metres from the house with access via a sloping path and 24 shallow steps.

We do have a mobility bus, which has a tailgate lift suitable for manual wheelchairs, to visit the house. **However, please note, the mobility bus is run solely by volunteers and although we try to provide a daily service there may be days when it is not running.** If your group requires the mobility bus, please let us know and we shall try to accommodate you.

Unfortunately, coaches cannot drive to the front of the house, however groups arriving by minibus can organise a drive and drop to the house if the mobility bus is not running.

Due to fire-safety concerns, we do have a restriction on the number of wheelchairs allowed in the house. At present we can welcome one wheelchair in every 30 minutes. Please do advise us in advance if this will affect your group.

There is only wheelchair access on the ground floor of the house, which includes the sitting room, hall, drawing room and library. In the sitting room, we do have a virtual tour and a photo album available.





Gardens

The gardens are situated on a hillside which do not lend themselves easily to wheelchair users.

Access to the upper part of the gardens is via the mobility bus only. This section of the gardens includes the croquet lawn, butterfly house, walled kitchen garden, Golden Rose Avenue, and views over both our orchard and the Sussex Weald.

Other facilities onsite are:

- Adapted toilets
- Braille and larger print on room cards
- Manual wheelchairs available on loan

Studio

The Studio has an accessible entrance, but to avoid steps the route to it is across a grass slope or down a steep paved slope.

Shop and Café

The shop and café are accessible from the upper level of the car park where there are additional designated parking bays, or from the ramped area to the left-hand side of the shop area.

There is a lift from the ground floor of the restaurant to our function facility the Mulberry Room where an accessible toilet is also available.

Make a booking

We recommend making a booking at least 3 months in advance.



Please contact our team today with:

- Group name
- Group leaders name
- Estimated Group Size
- Date of Visit
- Arrival Time

Once we have provisionally booked your visit, we will send you a booking form. To confirm the booking please complete and return the booking form at your earliest convenience. You can do this by emailing us on:

Chartwell.groupbooking@nationaltrust.org.uk

If you would prefer to speak to a member of our booking team then please call us on:

01732 868381

Your booking will not be confirmed until you have completed the booking form and we have acknowledged this via email or phone.



Timings

To get the best Chartwell experience, we recommend allowing 3–4 hours for your visit.

Attraction	Time
House	1 hour
Gardens	1 hour
Woodland	1 hour
Café and Shop	1 hour

Group Benefits

- Discounted admission for groups of 15 people or more.
- Pre-booked house entry.
- Complimentary admission for the group leader and driver.
- Free Coach Parking.
- Free familiarisation visit for the group leader.

Add-Ons

Guidebooks - At Chartwell, we offer guidebooks for the price of £5. Written by the house curator Katherine Carter and our previous head gardener Tim Parker, these books offer a history of the Churchills at Chartwell. They are available in English, French and German.

Prices

House, Studio and Garden

Adult: £ 20

Child: £ 10

Garden Only

Adult: £ 14

Child: £ 7

Free for National Trust Members

We offer a reduction of 10% on the admission prices (reduced prices shown above) for groups of 15 people or more. Payment for entrance fees may be made in advance or by cash/card on arrival or invoice if you have a National Trust Account.

Opening Times

Garden, Shop and Café

(Open all year; closed 24th and 25th December)

10:00–17:00

Please note that we close at 16:00 in winter.

House Timed Entries

25th February until the 31st October 2023.

First slot 11:00, last slot 15:40 (every ten minutes). Studio Opens at 11:30.

Bank Holidays

We regret we're unable to welcome groups on Bank Holidays when the property is at its busiest.

For school half terms, please be advised that we may reduce the numbers of groups on site per day.

Arrival Times

We welcome one group every 30 minutes at Chartwell, so each group gets a dedicated member of staff to greet them on their arrival. If your proposed time has already been booked, we will offer you an alternative.



Arrival times should be at least 30 minutes before house entry. This may increase to 45 minutes at peak times.

Annual Availability

February							March							April						
M	T	W	Th	F	S	S	M	T	W	Th	F	S	S	M	T	W	Th	F	S	S
		1	2	3	4	5			1	2	3	4	5						1	2
6	7	8	9	10	11	12	6	7	8	9	10	11	12	3	4	5	6	7	8	9
13	14	15	16	17	18	19	13	14	15	16	17	18	19	10	11	12	13	14	15	16
20	21	22	23	24	25	26	20	21	22	23	24	25	26	17	18	19	20	21	22	23
27	28						27	28	29	30	31			24	25	26	27	28	29	30

May							June							July						
M	T	W	Th	F	S	S	M	T	W	Th	F	S	S	M	T	W	Th	F	S	S
1	2	3	4	5	6	7				1	2	3	4						1	2
8	9	10	11	12	13	14	5	6	7	8	9	10	11	3	4	5	6	7	8	9
15	16	17	18	19	20	21	12	13	14	15	16	17	18	10	11	12	13	14	15	16
22	23	24	25	26	27	28	19	20	21	22	23	24	25	17	18	19	20	21	22	23
29	30	31					26	27	28	29	30			24	25	26	27	28	29	30
														31						

August							September							October						
M	T	W	Th	F	S	S	M	T	W	Th	F	S	S	M	T	W	Th	F	S	S
	1	2	3	4	5	6					1	2	3							1
7	8	9	10	11	12	13	4	5	6	7	8	9	10	2	3	4	5	6	7	8
14	15	16	17	18	19	20	11	12	13	14	15	16	17	9	10	11	12	13	14	15
21	22	23	24	25	26	27	18	19	20	21	22	23	24	16	17	18	19	20	21	22
28	29	30	31				25	26	27	28	29	30		23	24	25	26	27	28	29
														30	31					

 Not Available for Group Bookings  Available for Group Bookings

Please note that all dates are subject to change/availability

Guided Tours

At Chartwell we can offer a range of private guided tours with our specialist room guides for groups of 9-30 members.

1 hour Private House Tour and General Admission to the Gardens

£40 per person (non-members)

£20 per person (members)

The tour takes place on a Monday only at 10am before the house is open to the public and is subject to room guide availability.

Please get in touch if you are interested in this tour and our team will be more than happy to assist you.



1 hour Private House Tour including the 'Introduction to the Studio' and General Admission to the Gardens

£50 per person (non-members)

£30 per person (members)

This tour takes place on a Monday only at 10am before the house is open to the public. After this exclusive group viewing you will be taken down to Churchill's Studio which houses his famous paintings and given a private introduction to the studio. Afterwards your group are free to visit the gardens at their leisure.

Studio Tours Only

£30 per person (non-members)

£10 per person (members)

Again, taking place on a Monday before public opening hours, your group will have an exclusive half an hour tour of the studio led by one of our expert guides. This tour will introduce you to Winston Churchill the painter and his love of art. After your tour this package grants your group access to the house and grounds.

Additional Talks/ Tours

These are led entirely by our volunteers so are subject to availability on a daily basis.



Studio Talks

Few people know the story of Churchill the artist. In this daily talk our studio stewards guide you through the progression of Churchills style and his artistic influencers. They usually take place at 12:30 and 14:30. Please ask the visitor centre to see if the tour is running on the day of your visit.

Garden Talks

Join our gardeners for there daily talk at 14:00 in the Marlborough Pavilion and discover the history and evolution of the gardens. The route will take you up to the North Downs, across the lakes, then through the terrace gardens. The tour guides will identify plants and trees and answer any questions you may have. This tour is subject to the availability of the garden team, so please ask the Visitor Centre to see if the tour is running.



Terms and Conditions

- Please note that we will confirm your booking via email only after we have received a completed booking form. If any changes are to be made, please contact us at least two weeks prior to your booking.
- To be eligible for the group rate you must pay in one transaction and consist of 15 people or more in your party.
- Final visitor numbers must be confirmed no later than 7 days before your visit. Once we have received these, that is the number of tickets which must be paid for on the day as we will not be able to resell them.
- Please be advised entry to the house cannot be guaranteed if a group misses their agreed entry time
- Groups are responsible for managing their own journey time and delays.

Cancellation

Please note that should you chose to cancel your group booking we require a minimum of 7 days notice. If you cancel at any point after this time, an administration fee of £50 will be invoiced to you.

Where next?

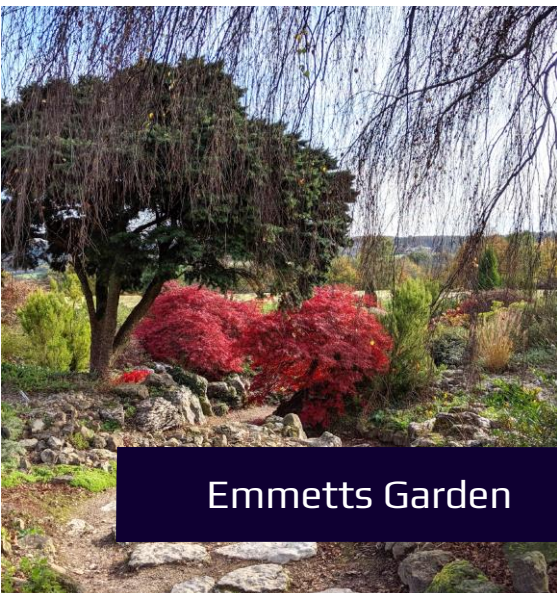

Emmetts Garden



Quebec House

Site Map

Map Key

- Car Park
 - Toilets
 - Visitor Welcome Centre, Information & Tickets
 - Swings
 - Accessible Toilet
 - Viewpoint
 - Shop
 - Steps
 - Baby Changing Facilities
 - Mobility Bus to front of house
 - Cafe
 - Picnic Area
 - Second-hand Bookshop
 - Self-led family fun
- Our hillside location means that the grounds are sloped in places with steps and terraces.
- Self-led estate walk
 - Suggested wheelchair and pushchair route
 - Steep gradient

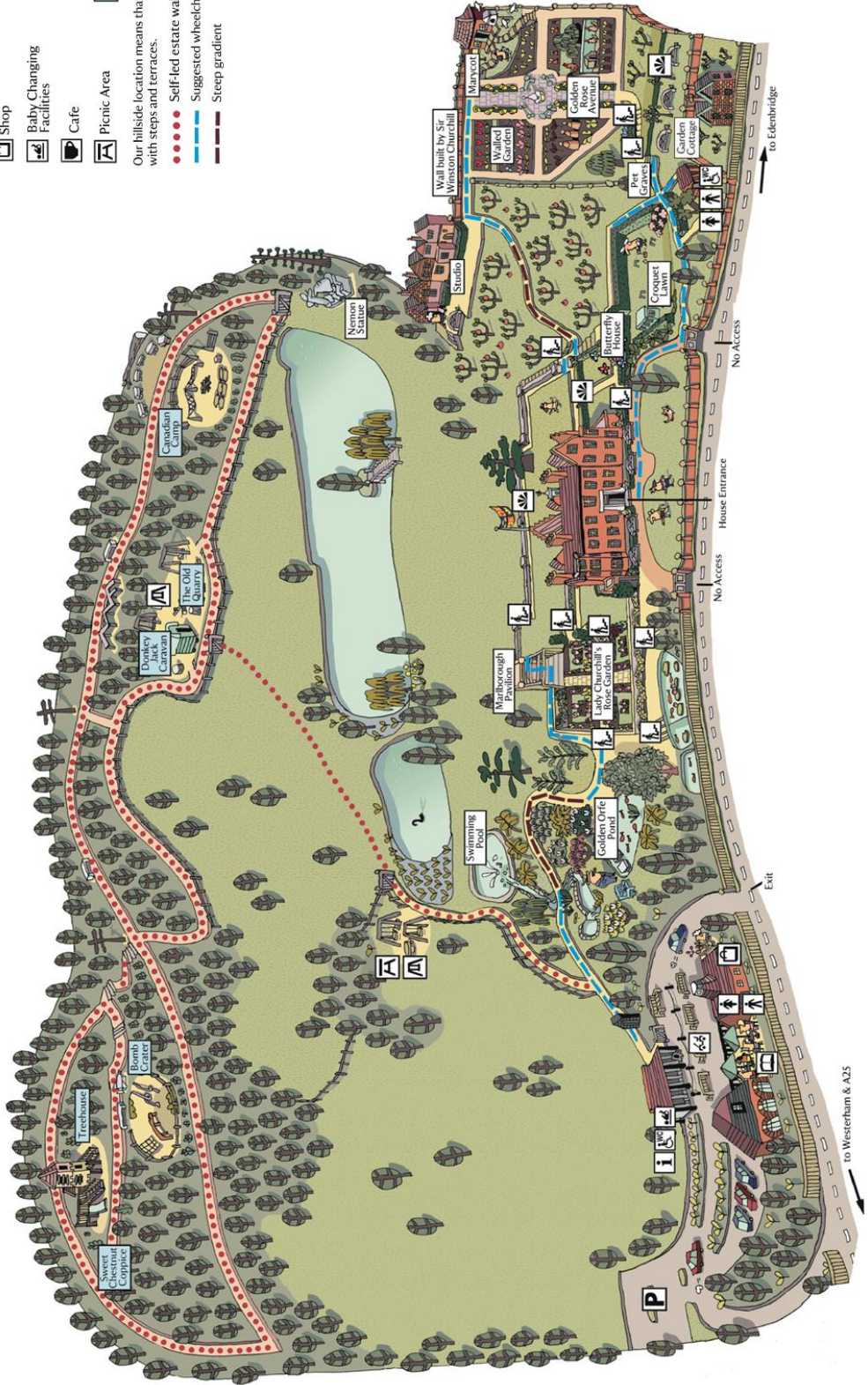

Front cover image

©National Trust Images/Chris Jonas

Main images

©National Trust Images/Kate York / Kate Dickinson / Flo Smith /
Arnhel de Serra / Sarah Haile / Andrew Butler / Chris Jonas /
Andrew Butler / Robert Morris / David Sellman / Andreas von
Einsiedel

©National Trust 2023

The National Trust is a registered charity no. 205846

[nationaltrust.org.uk](https://www.nationaltrust.org.uk)